

## BALLROOM - FLOOR PLAN

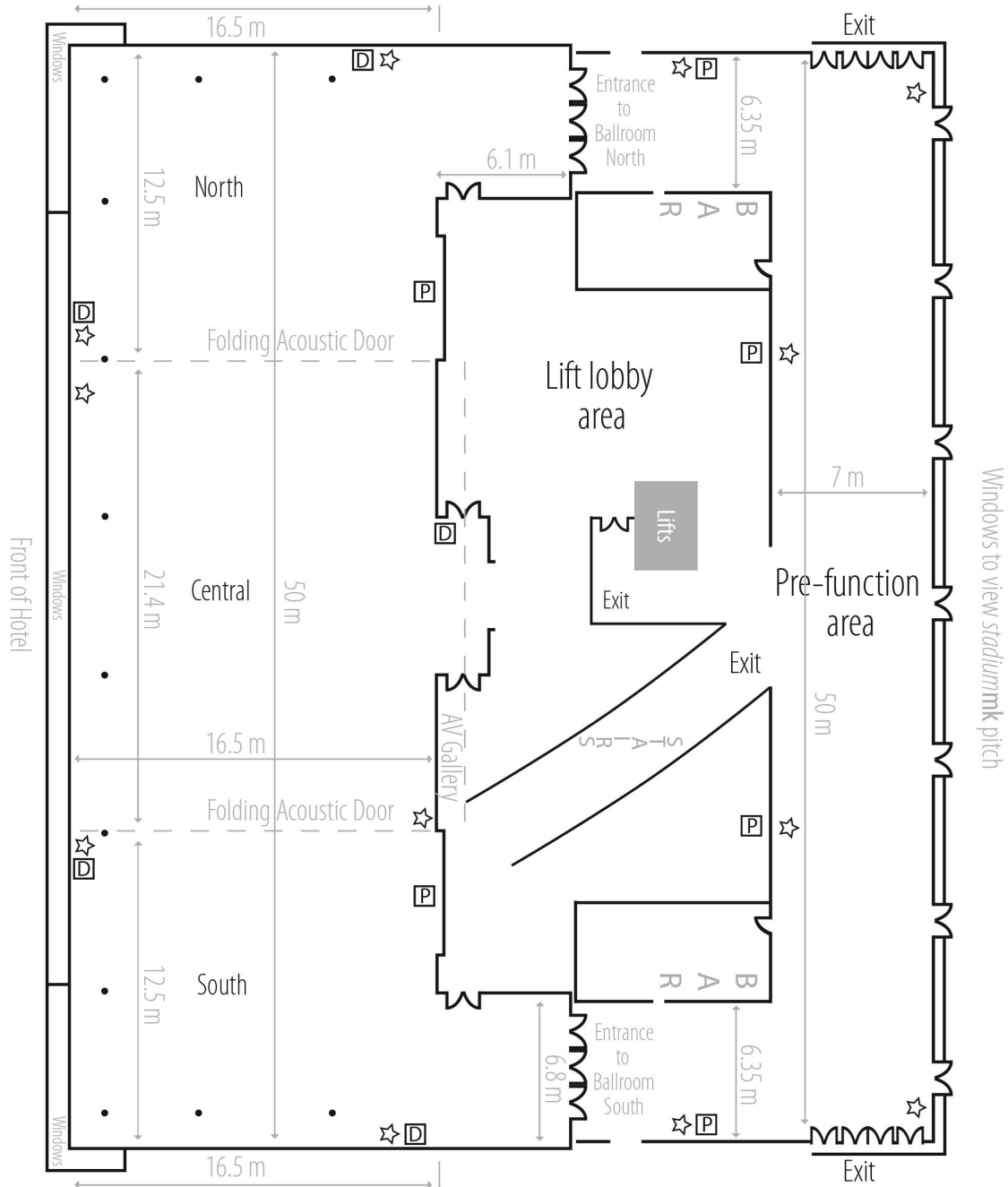

### Key

- ☆ Power - 3 phase power available
- Data point
- ▣ Plasma screen.  
Built in PA System.  
Microphone connectivity available

### Access Point

Although the Ballroom is situated on Level 1, deliveries are made to Gate 1 which is located at ground level. All drivers must first report to hotel reception.

### Ceiling Load Bearing

Ceiling access points run parallel and horizontal with columns, there is a six ton even load bearing.

For equipment hire prices please speak to one of our Event Co-ordinators

T: 0845 45 45 045

e: [sales@hotelmk.co.uk](mailto:sales@hotelmk.co.uk)

w: [doubletreebyhiltonmiltonkeynes.co.uk](http://doubletreebyhiltonmiltonkeynes.co.uk)

w: [arenamk.com](http://arenamk.com)

*DoubleTree by Hilton Milton Keynes*

# DISCOVERY, ENTERPRISE, PIONEER, VOYAGER & EXPLORER - FLOOR PLAN

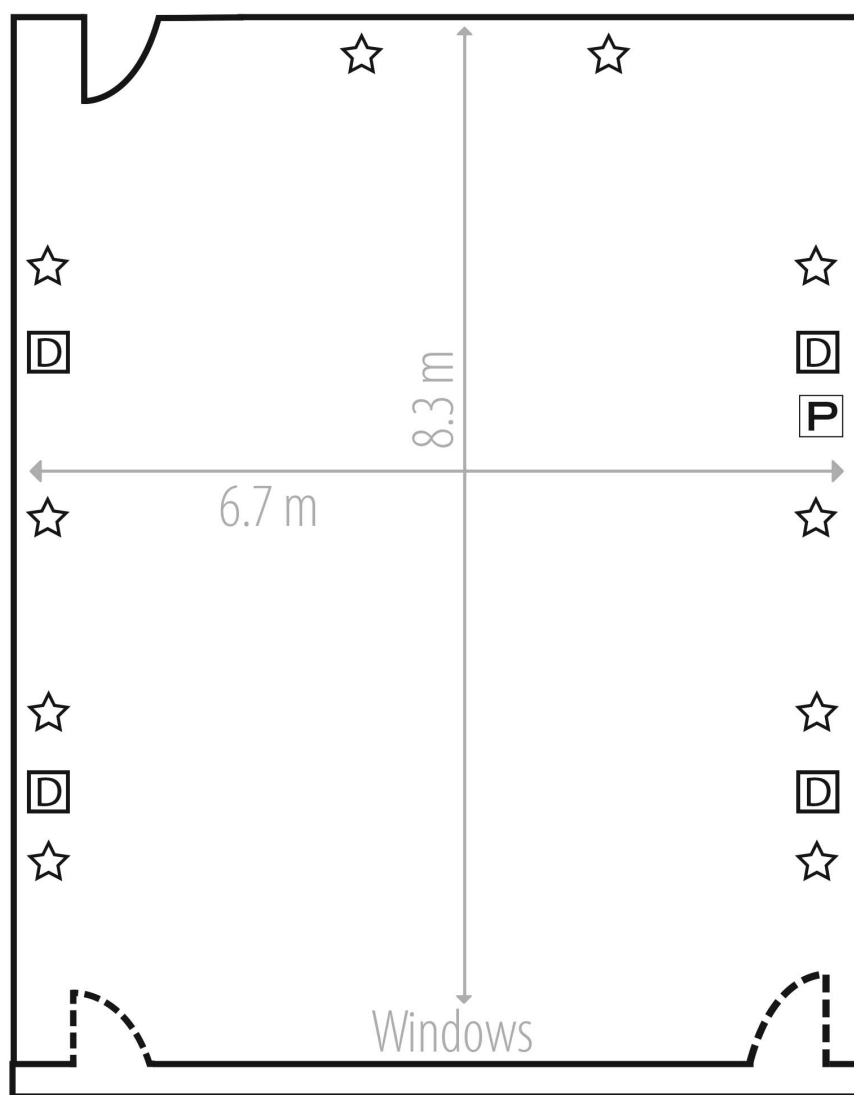

## Key

- D Data point
- ☆ Power
- P 50" plasma TV with VGA/DVI and IPTV connectivity

For equipment hire prices please speak to one of our Event Co-ordinators

T: 0845 45 45 045

e: [sales@hotelmk.co.uk](mailto:sales@hotelmk.co.uk)

w: [doubletreebyhiltonmiltonkeynes.co.uk](http://doubletreebyhiltonmiltonkeynes.co.uk)

w: [arenamk.com](http://arenamk.com)

*DoubleTree by Hilton. Where the little things mean everything.™*

These plans are intended for illustration purposes only and are not to scale.

PERFORMANCE - FLOOR PLAN

Key

- ◁ Speakers x2, wall mounted

..... Projector Screen, 2032mm x 1524mm

TV TVs x2, 42" TVs with VGA and HDMI connections
- Projector 4200 Lumen, IPTV connectivity, VGA, HDMI and 3.5mm jack wall plate

▢ Data point

☆ Power

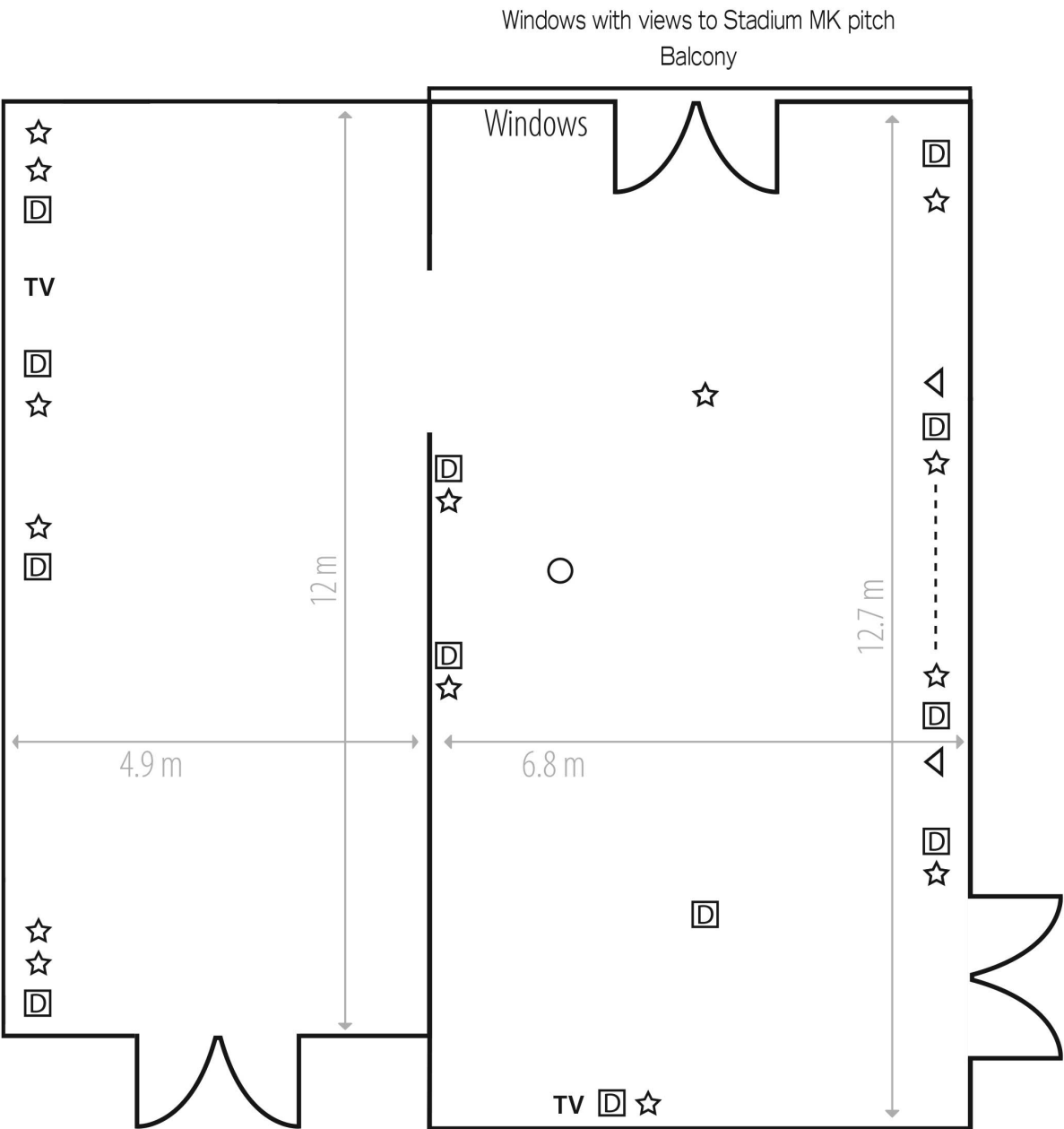

For equipment hire prices please speak to one of our Event Co-ordinators

T: 0845 45 45 045    e: [sales@hotelmk.co.uk](mailto:sales@hotelmk.co.uk)    w: [doubletreebyhiltonmiltonkeynes.co.uk](http://doubletreebyhiltonmiltonkeynes.co.uk)    w: [arenamk.com](http://arenamk.com)

PLAYERS' SUITE - FLOOR PLAN

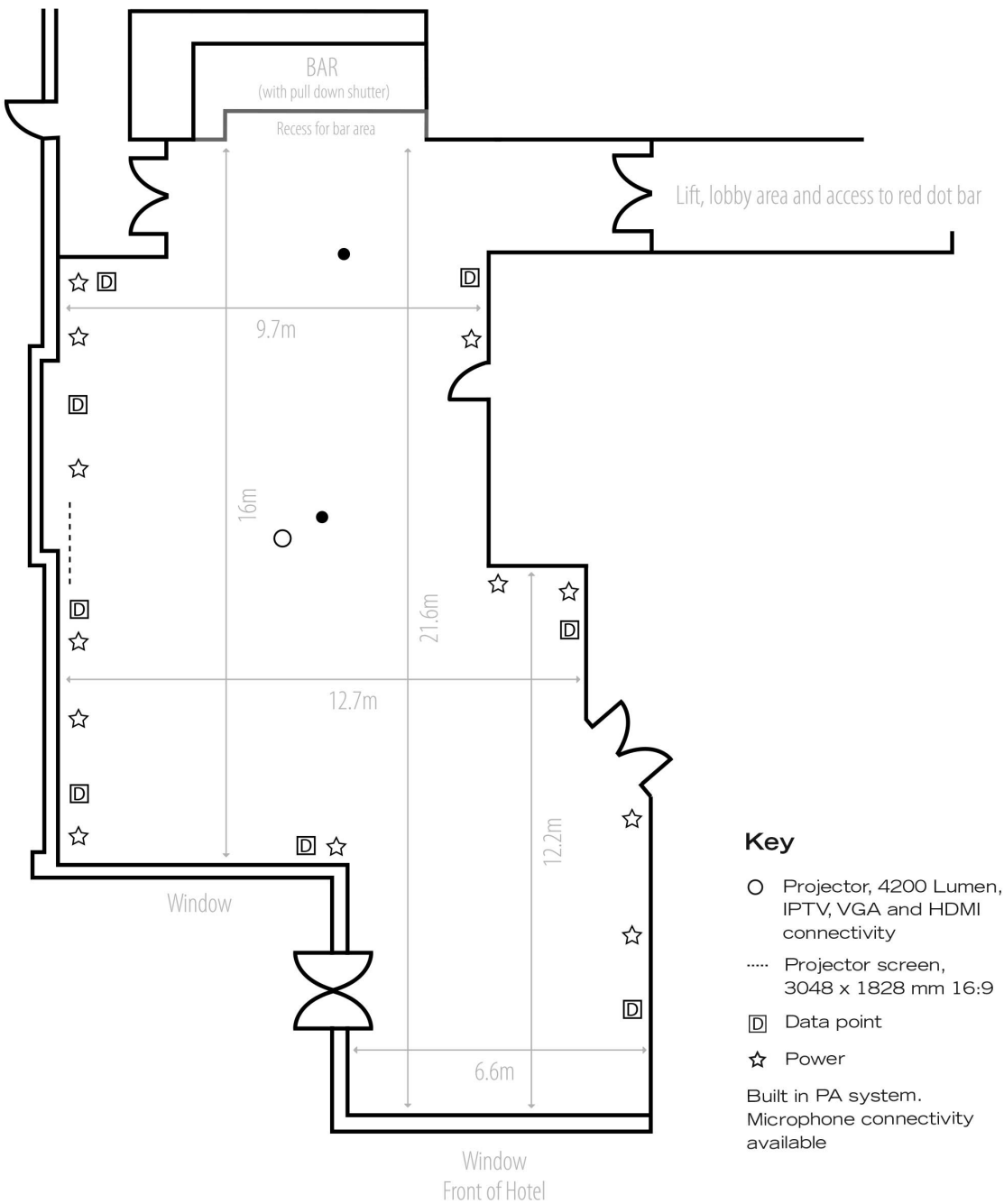

For equipment hire prices please speak to one of our Event Co-ordinators

T: 0845 45 45 045    e: sales@hotelmk.co.uk    w: doubletreebyhiltonmiltonkeynes.co.uk    w: arenamk.com

red dot bar - FLOOR PLAN

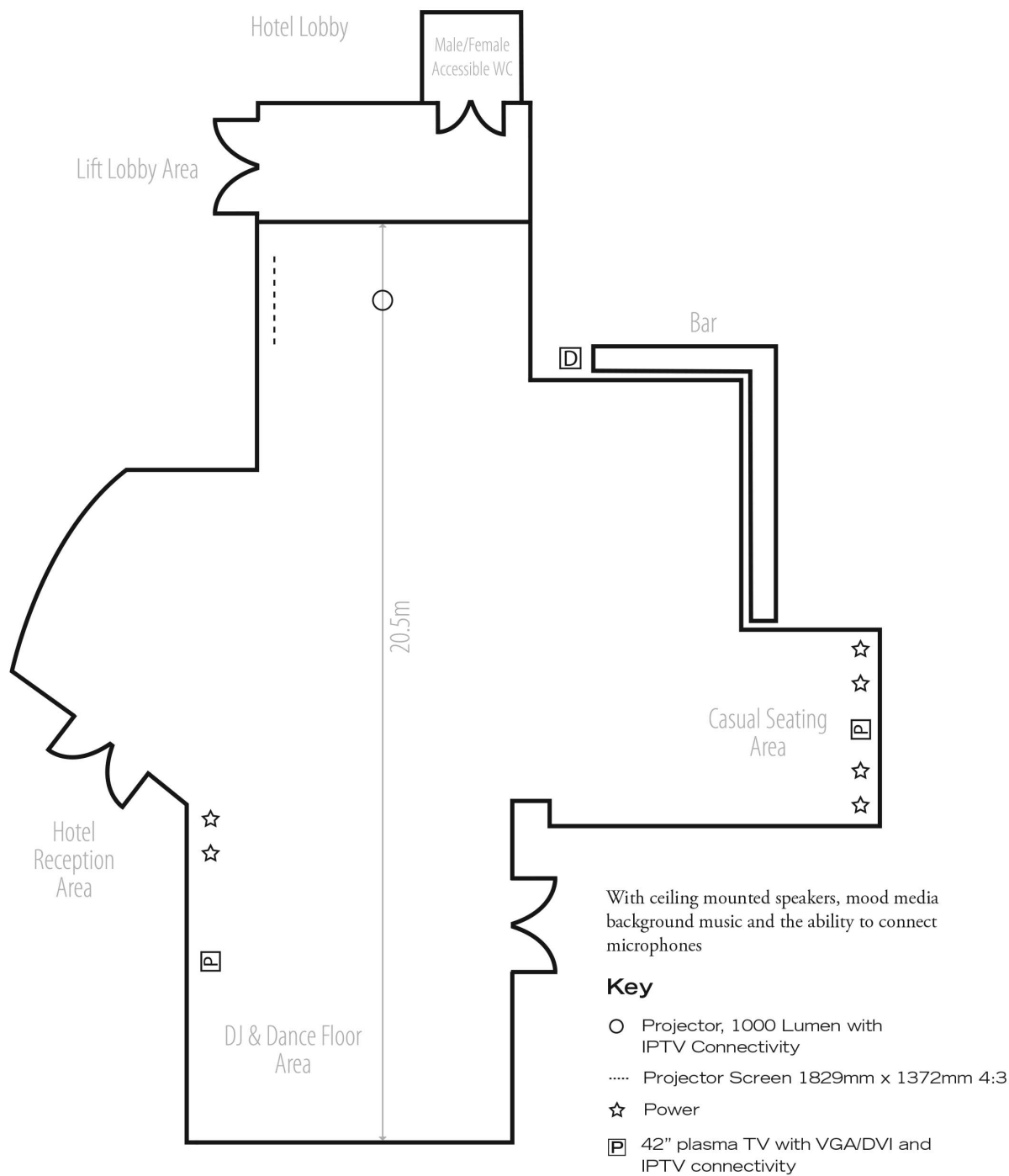

For equipment hire prices please speak to one of our Event Co-ordinators

T: 0845 45 45 045    e: sales@hotelmk.co.uk    w: doubletreebyhiltonmiltonkeynes.co.uk    w: arenamk.com

DoubleTree by Hilton. Where the little things mean everything.™

These plans are intended for illustration purposes only and are not to scale.

SKILLS & ANALYSIS - FLOOR PLAN

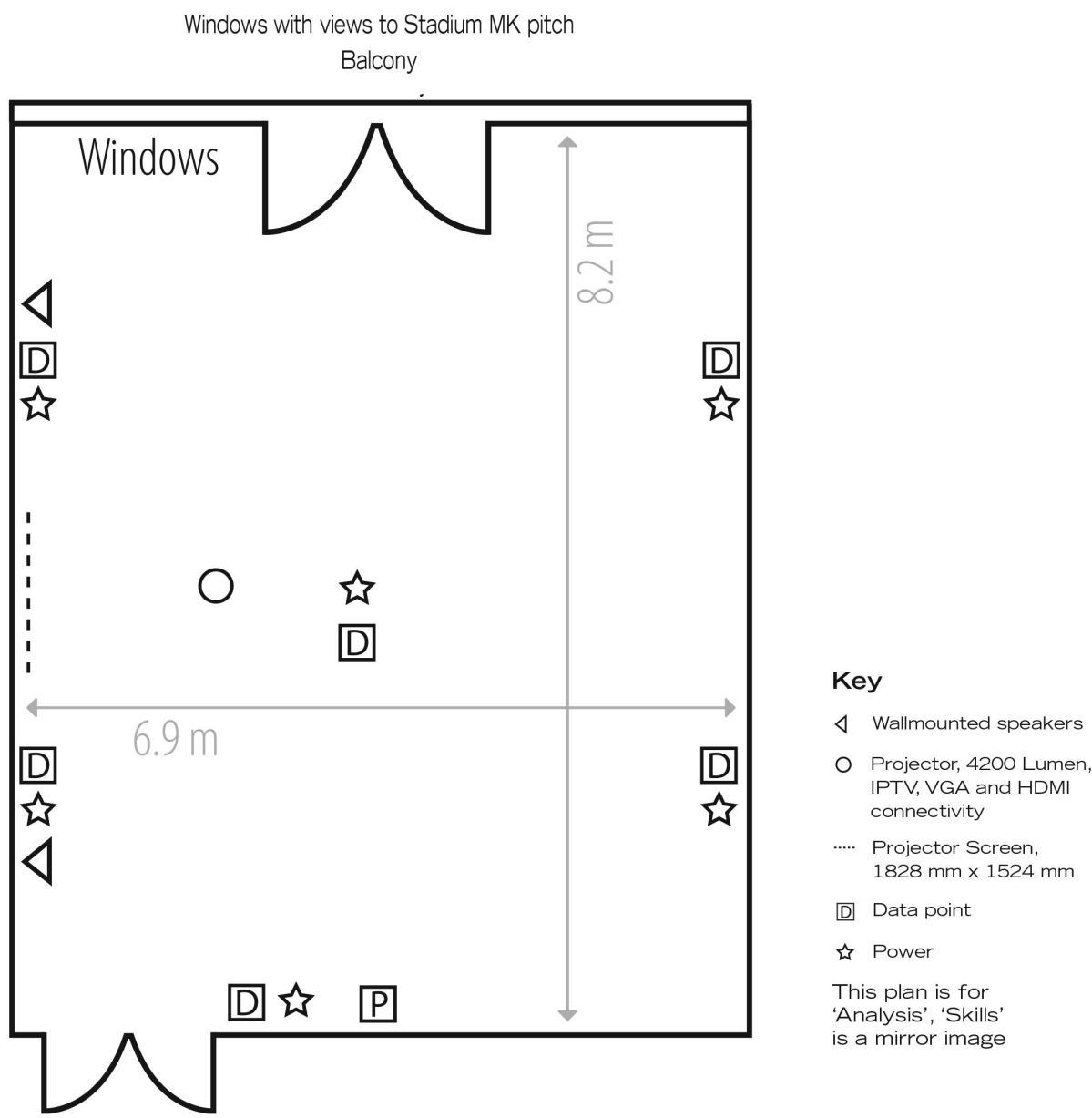

For equipment hire prices please speak to one of our Event Co-ordinators

T: 0845 45 45 045    e: sales@hotelmk.co.uk    w: doubletreebyhiltonmiltonkeynes.co.uk    w: arenamk.com

TACTICS - FLOOR PLAN

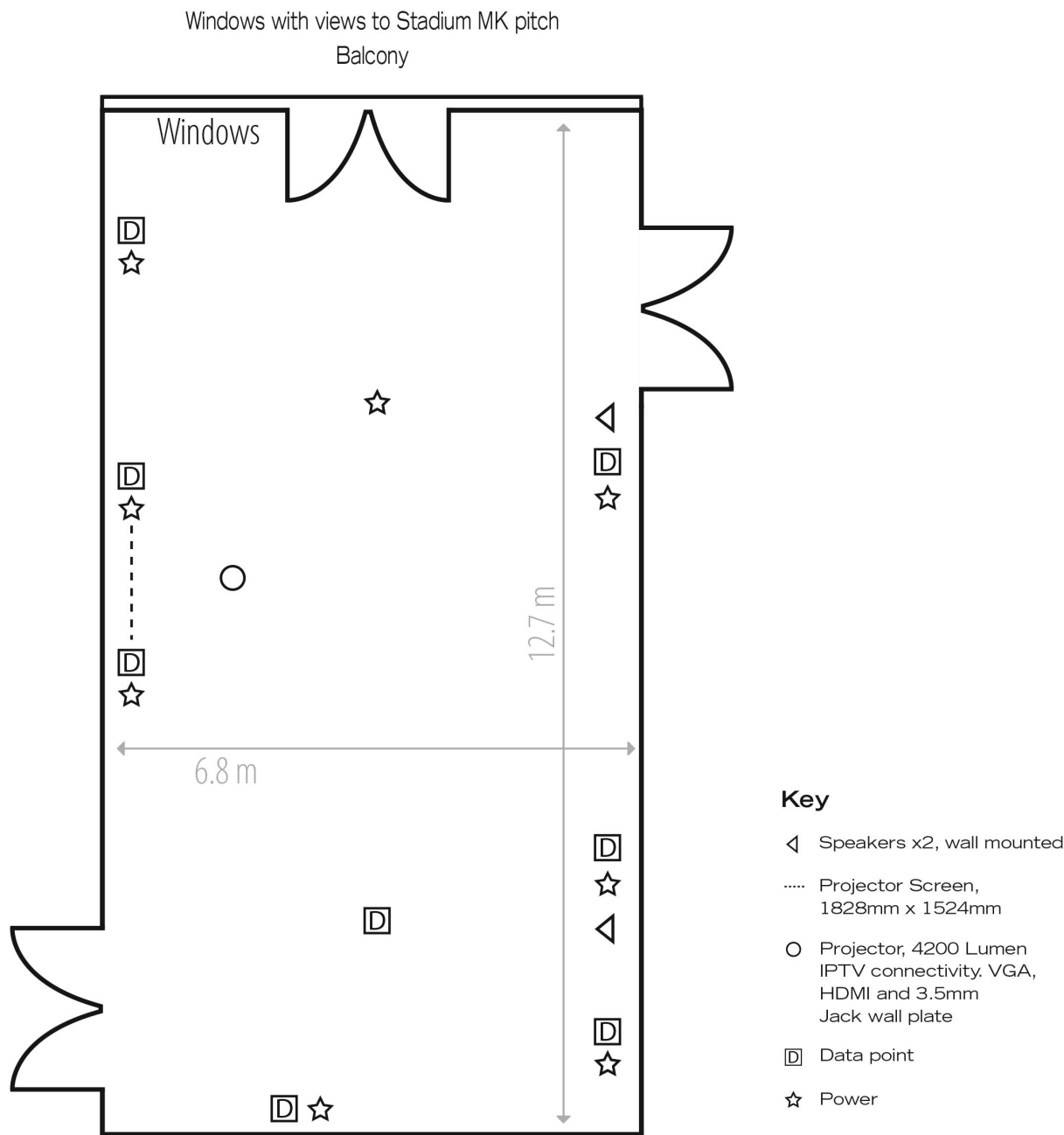

For equipment hire prices please speak to one of our Event Co-ordinators

T: 0845 45 45 045    e: [sales@hotelmk.co.uk](mailto:sales@hotelmk.co.uk)    w: [doubletreebyhiltonmiltonkeynes.co.uk](http://doubletreebyhiltonmiltonkeynes.co.uk)    w: [arenamk.com](http://arenamk.com)

DoubleTree by Hilton. Where the little things mean everything.™

These plans are intended for illustration purposes only and are not to scale.

# FLOOR PLANS

**LEVEL 0** - 2,728m<sup>2</sup> / 54m x 45m

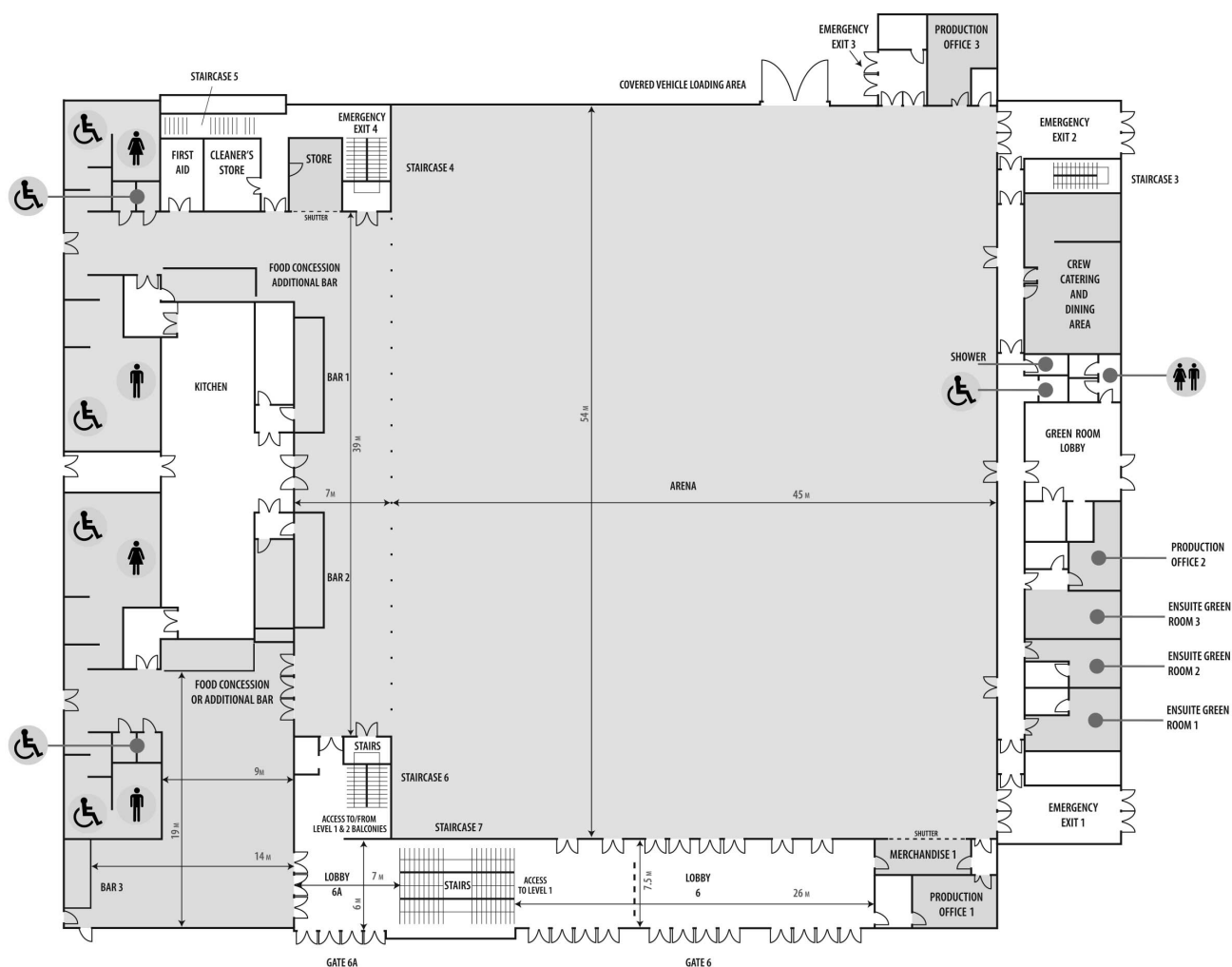

MAIN ARENA FLOOR

SEPARATE BAR/REGISTRATION AREA

BACK OF HOUSE SPACES

This plan and the one on the following page is intended to provide you with information on how the spaces connect along with suggestions for usage. For a detailed CAD drawing, please contact our Conference and Event Team.

## Key





Marshall

ARENA

MK

FLOOR PLANS

BALCONY  
LEVEL 1

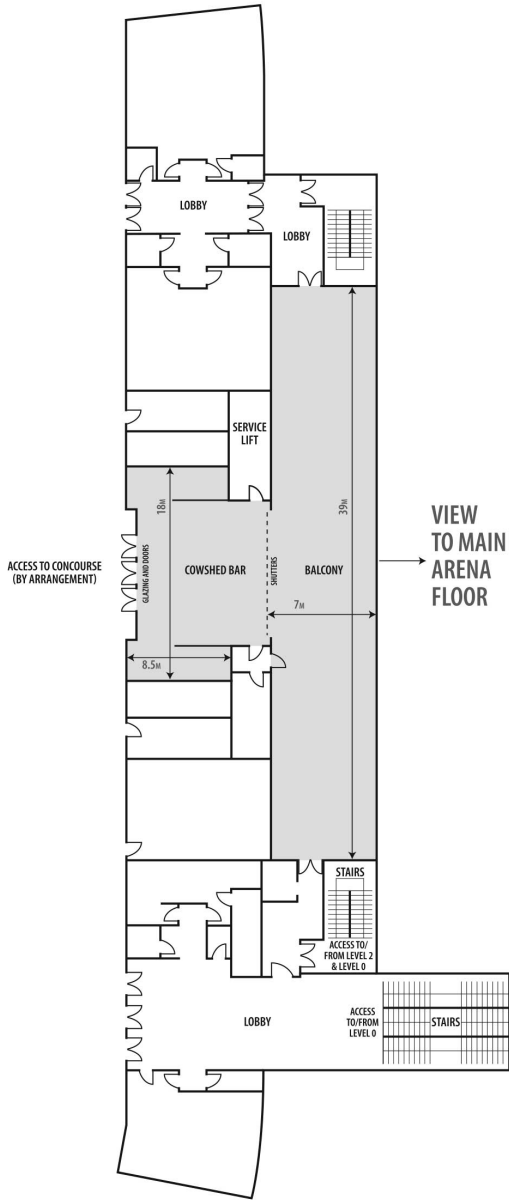

BALCONY  
LEVEL 2

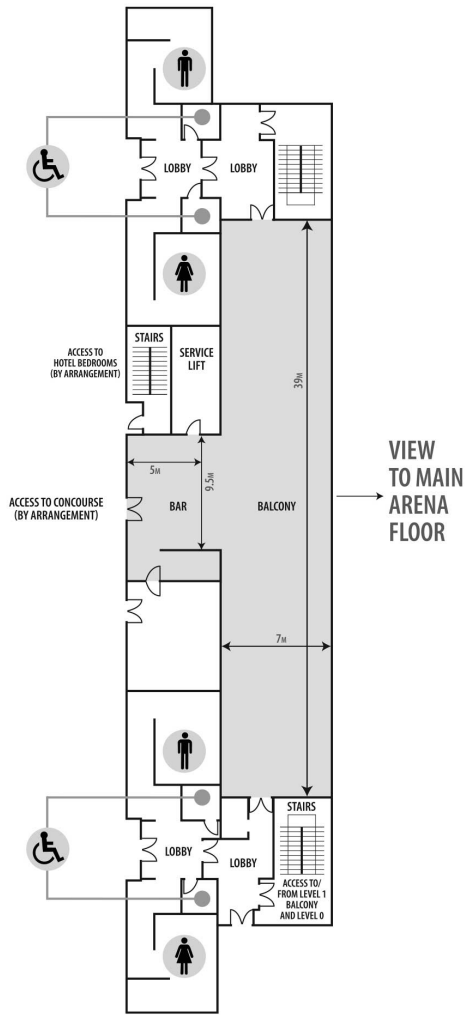

SEPARATE BAR/REGISTRATION AREA

Key

