



## JOCKEY CLUB VENUES HAYDOCK PARK







ICONIC VENUES WITH A UNIQUE RACING HERITAGE



MAKERSFIELD STAND

### Park Suite

Located on the second floor of the Makerfield Stand and offering superb views over the racecourse, the newly refurbished Park Suite is the ideal choice for those looking for an impressive, modern space catering for up to 500 delegates. This large room can also be split into three sections each holding approximately 150 delegates.

	Theatre	500
	Boardroom	-
	Cabaret	350
	Classroom	-
	Dinner	450
	Dinner Dance	420

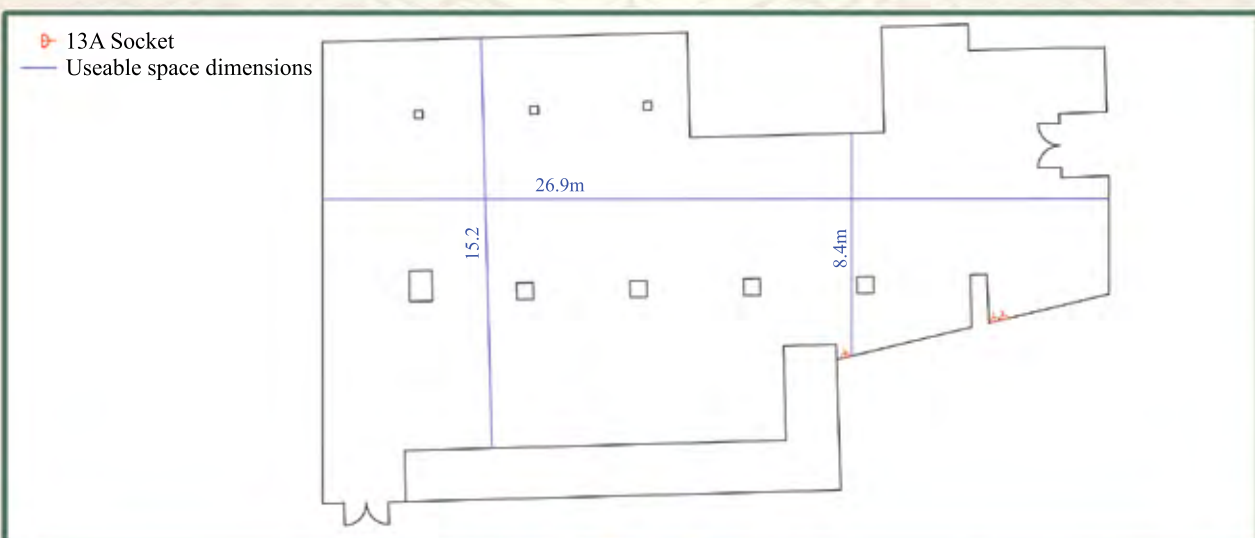

## JOCKEY CLUB VENUES

Contact us on : 01942 402623 / [haydockevents@thejockeyclub.co.uk](mailto:haydockevents@thejockeyclub.co.uk)  
 ICONIC VENUES WITH A UNIQUE RACING HERITAGE

**JOCKEY CLUB VENUES**  
**HAYDOCK PARK**

ICONIC VENUES WITH A UNIQUE RACING HERITAGE



COUNTY STAND

**Premier Bar**

Fresh, contemporary and ever so stylish, the Premier Suite is suited for both dinners and conferences of up to 200 guests. It even has its own conservatory to the rear which is the perfect spot for drinks receptions. As this suite is located on the second floor, it has direct access to the Tommy Whittle Stand's six syndicate rooms and thirty boxes, it's ideal for multi-room conferences or exhibitions.

	Theatre	200
	Boardroom	45
	Cabaret	120
	Classroom	80
	Dinner	250
	Dinner Dance	220

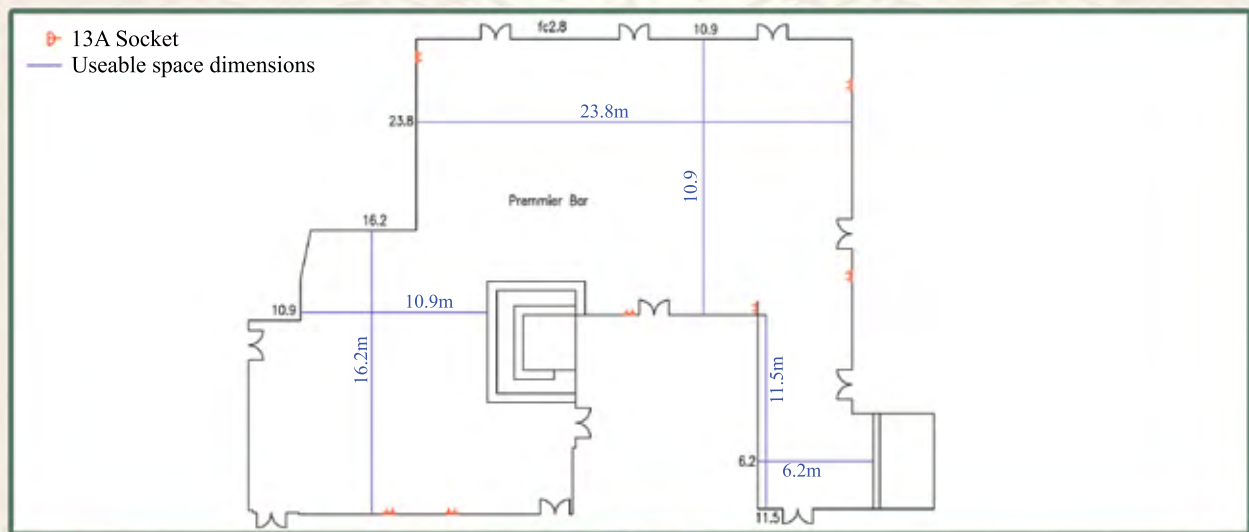

**JOCKEY CLUB VENUES**

Contact us on : 01942 402623 / [haydockevents@thejockeyclub.co.uk](mailto:haydockevents@thejockeyclub.co.uk)  
 ICONIC VENUES WITH A UNIQUE RACING HERITAGE



## JOCKEY CLUB VENUES HAYDOCK PARK







ICONIC VENUES WITH A UNIQUE RACING HERITAGE



CENTENARY STAND

### The Horseshoe Suite

Part of the Centenary Stand, with a large balcony area overlooking the racecourse, this suite is ideally suited for dinners, conferences, exhibitions and training days.

	Theatre	150
	Boardroom	40
	Cabaret	80
	Classroom	80
	Dinner	220
	Dinner Dance	200

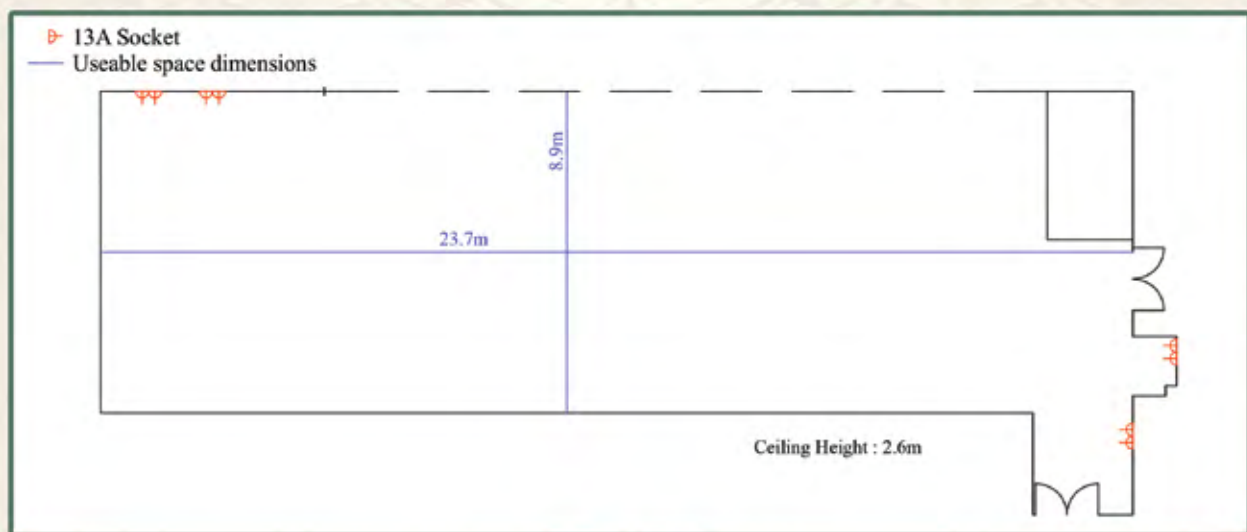

## JOCKEY CLUB VENUES

Contact us on : 01942 402623 / [haydockevents@thejockeyclub.co.uk](mailto:haydockevents@thejockeyclub.co.uk)  
 ICONIC VENUES WITH A UNIQUE RACING HERITAGE



## JOCKEY CLUB VENUES HAYDOCK PARK







ICONIC VENUES WITH A UNIQUE RACING HERITAGE



TOMMY WHITTLE STAND

### Jubilee Suite

Ideal for seminars and presentations for up to eighty delegates, the Jubilee Suite is located on the ground floor, with a stunning conservatory leading out onto the famous Haydock Park parade ring.

	Theatre	80
	Boardroom	30
	Cabaret	60
	Classroom	42
	Dinner	120
	Dinner Dance	120

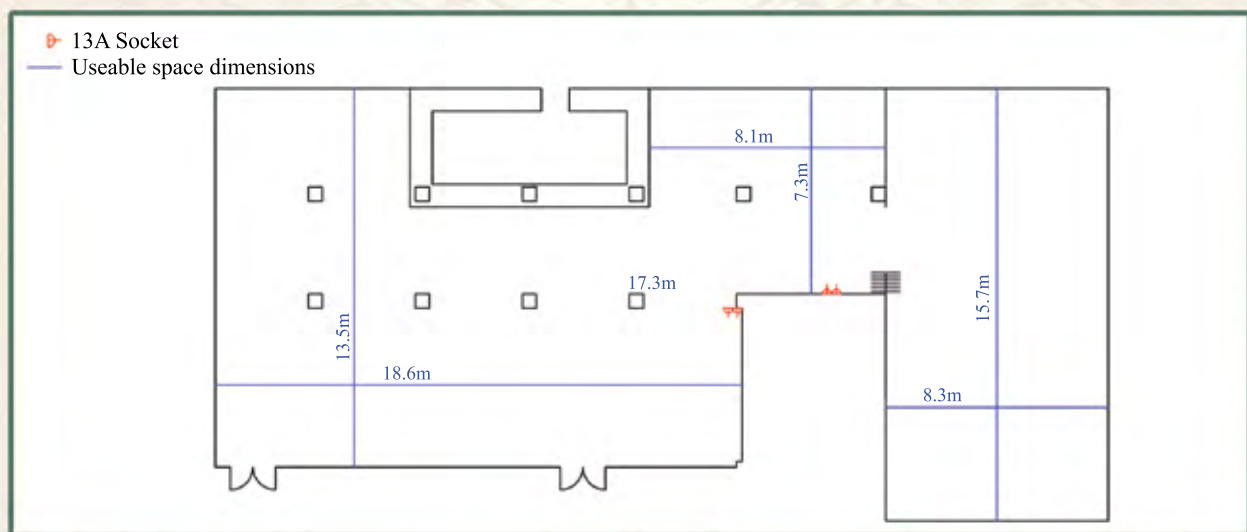

## JOCKEY CLUB VENUES

Contact us on : 01942 402623 / [haydockevents@thejockeyclub.co.uk](mailto:haydockevents@thejockeyclub.co.uk)  
 ICONIC VENUES WITH A UNIQUE RACING HERITAGE



## JOCKEY CLUB VENUES HAYDOCK PARK

ICONIC VENUES WITH A UNIQUE RACING HERITAGE



### TOMMY WHITTLE STAND

## Whittles

Whittles can comfortably accommodate up to 100 delegates, making it ideal for seminars, presentations and small wedding receptions.

	Theatre	100
	Boardroom	30
	Cabaret	60
	Exhibition	60
	Dinner	120
	Dinner Dance	100

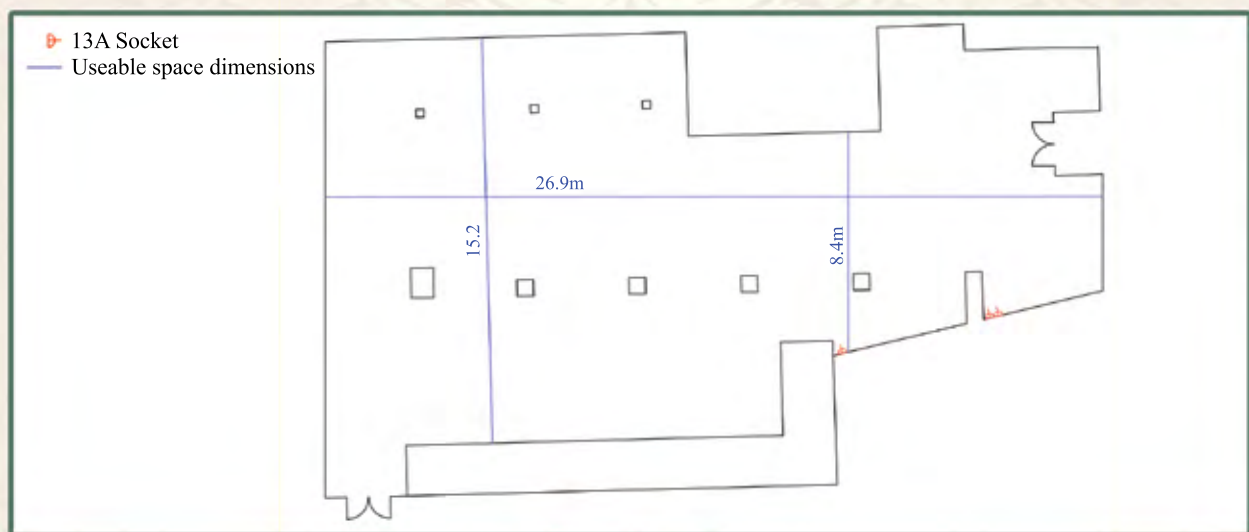

## JOCKEY CLUB VENUES

Contact us on : 01942 402623 / [haydockevents@thejockeyclub.co.uk](mailto:haydockevents@thejockeyclub.co.uk)  
 ICONIC VENUES WITH A UNIQUE RACING HERITAGE

  
**JOCKEY CLUB VENUES**  
**HAYDOCK PARK**







ICONIC VENUES WITH A UNIQUE RACING HERITAGE



TOMMY WHITTLE STAND

## Davies Suite

Located on the 3rd floor of the Tommy Whittle Stand, the Davies Suite is ideal for smaller meetings between 10 and 40 delegates. With an interconnecting room, it can be flexible to suit your needs and double up.

	Theatre	40
	Boardroom	24
	Cabaret	40
	Classroom	24
	Dinner	-
	Dinner Dance	-

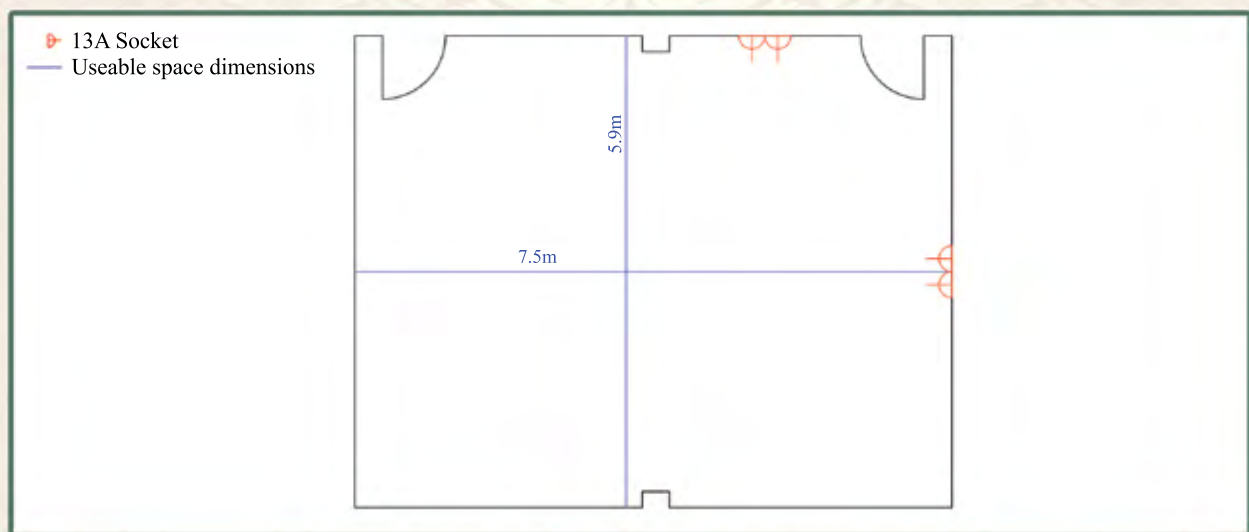

  
**JOCKEY CLUB VENUES**

Contact us on : 01942 402623 / [haydockevents@thejockeyclub.co.uk](mailto:haydockevents@thejockeyclub.co.uk)  
 ICONIC VENUES WITH A UNIQUE RACING HERITAGE



## JOCKEY CLUB VENUES HAYDOCK PARK







ICONIC VENUES WITH A UNIQUE RACING HERITAGE



TOMMY WHITTLE STAND

### Double Box

Located within the Tommy Whittle Stand, each double box boasts stunning views overlooking the racetrack and can cater for 24 guests for private dinner or conference.

	Theatre	-
	Boardroom	24
	Cabaret	-
	Classroom	24
	Dinner	24
	Dinner Dance	-

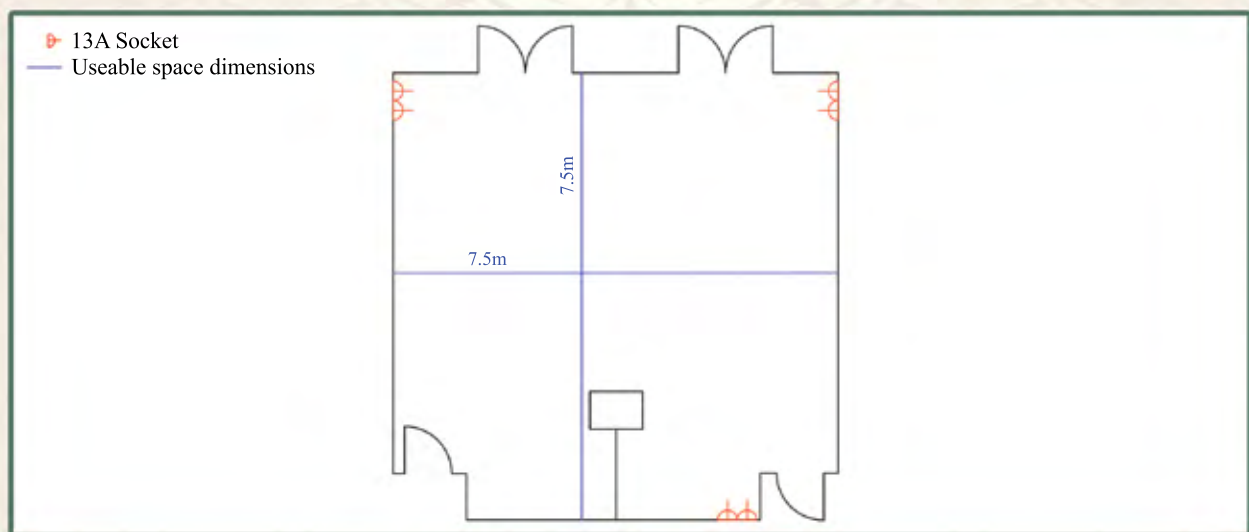

## JOCKEY CLUB VENUES

Contact us on : 01942 402623 / [haydockevents@thejockeyclub.co.uk](mailto:haydockevents@thejockeyclub.co.uk)  
 ICONIC VENUES WITH A UNIQUE RACING HERITAGE



## JOCKEY CLUB VENUES HAYDOCK PARK







ICONIC VENUES WITH A UNIQUE RACING HERITAGE



COUNTY STAND

### Sandon/Lancaster Suite

Located on the Ground Floor of the Centenary Stand, the Lancaster Suite is a popular choice for dinners, conferences and exhibitions, with large private bar facility and lounge area.

	Theatre	200
	Boardroom	50
	Cabaret	100
	Classroom	100
	Dinner	240
	Dinner Dance	220

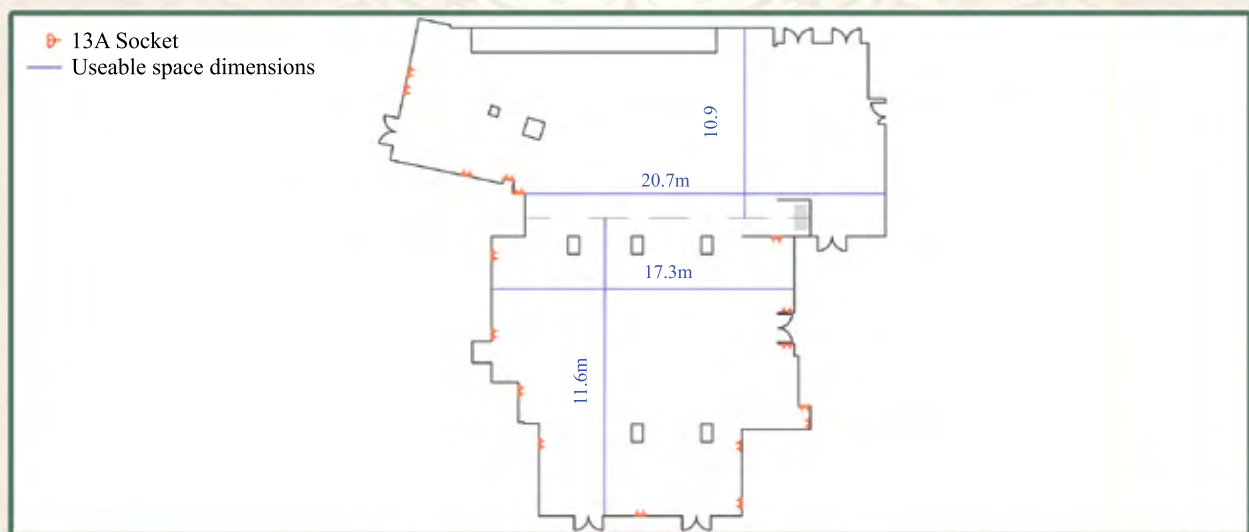

## JOCKEY CLUB VENUES

Contact us on : 01942 402623 / [haydockevents@thejockeyclub.co.uk](mailto:haydockevents@thejockeyclub.co.uk)  
 ICONIC VENUES WITH A UNIQUE RACING HERITAGE



**JOCKEY CLUB VENUES**  
**HAYDOCK PARK**

ICONIC VENUES WITH A UNIQUE RACING HERITAGE



TOMMY WHITTLE STAND

**The Boardroom**

Located on the contemporary fourth floor of the Tommy Whittle Stand, the impressive Boardroom which has been recently refurbished is an ideal setting for private dining or boardroom meetings for up to 24 delegates

	Theatre	-
	Boardroom	24
	Cabaret	-
	Classroom	-
	Dinner	24
	Dinner Dance	-

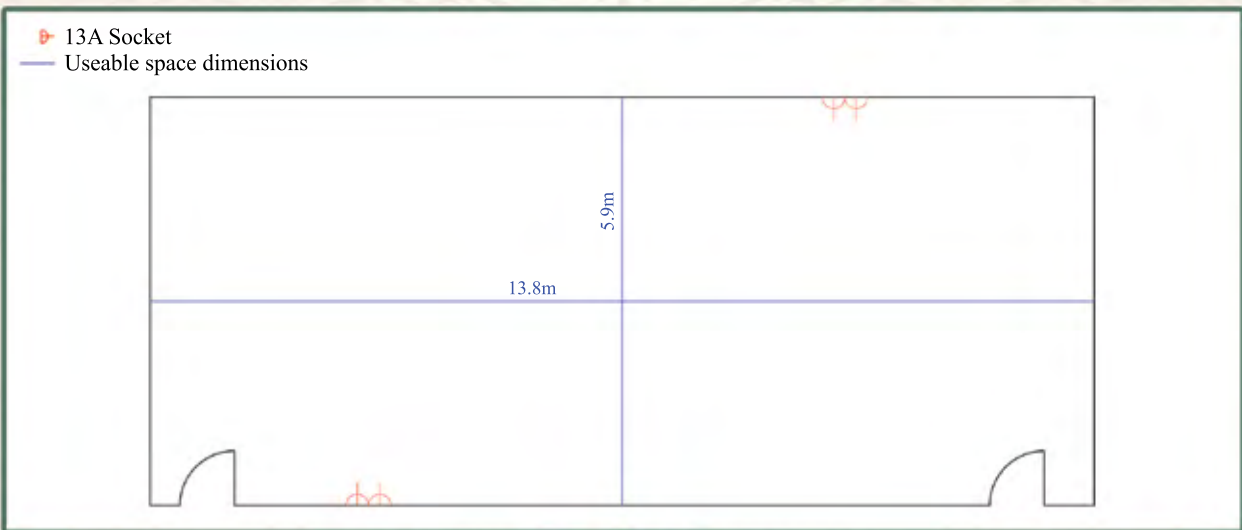

**JOCKEY CLUB VENUES**

Contact us on : 01942 402623 / [haydockevents@thejockeyclub.co.uk](mailto:haydockevents@thejockeyclub.co.uk)  
 ICONIC VENUES WITH A UNIQUE RACING HERITAGE