

## The Bobby Room, Lower Floor - Floorplan

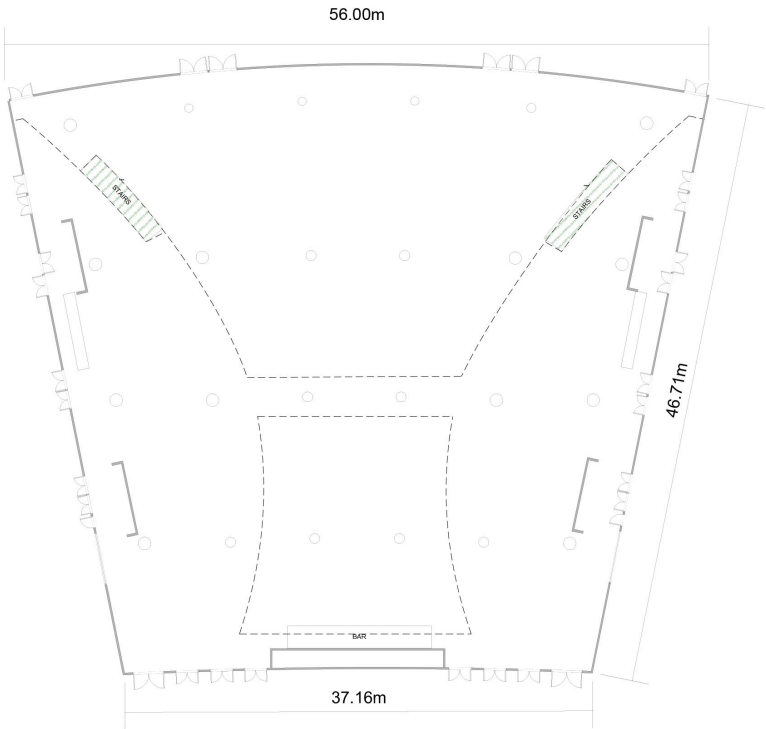

## Atrium

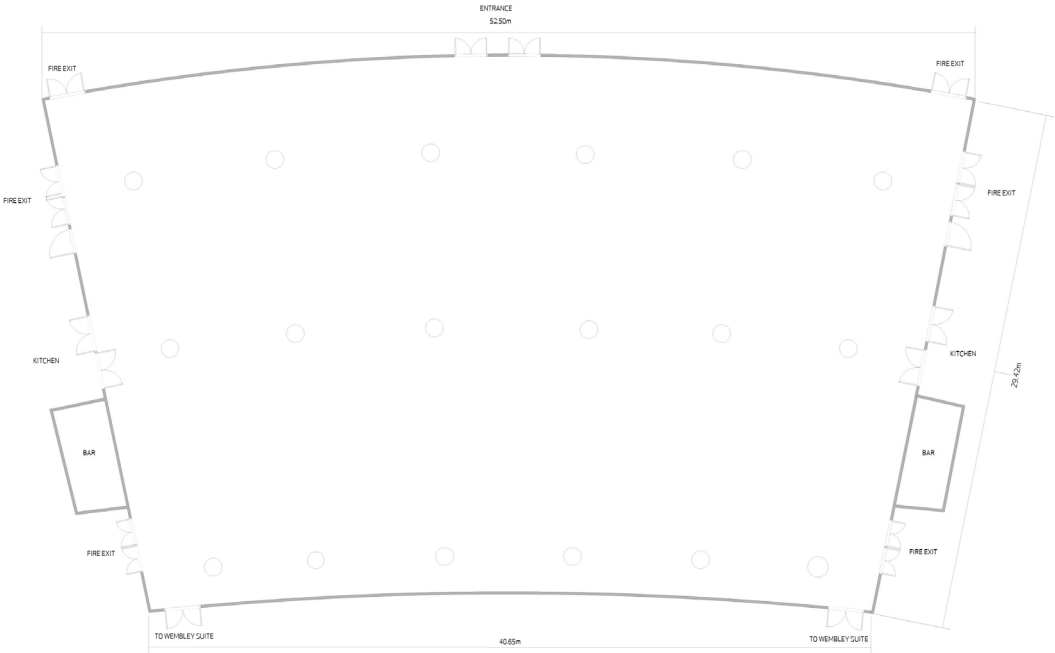

Height of ceiling – 2.80m

Approximate overall room size – 1400m<sup>2</sup>

Three phase power available upon request

## The Great Hall - Floorplan

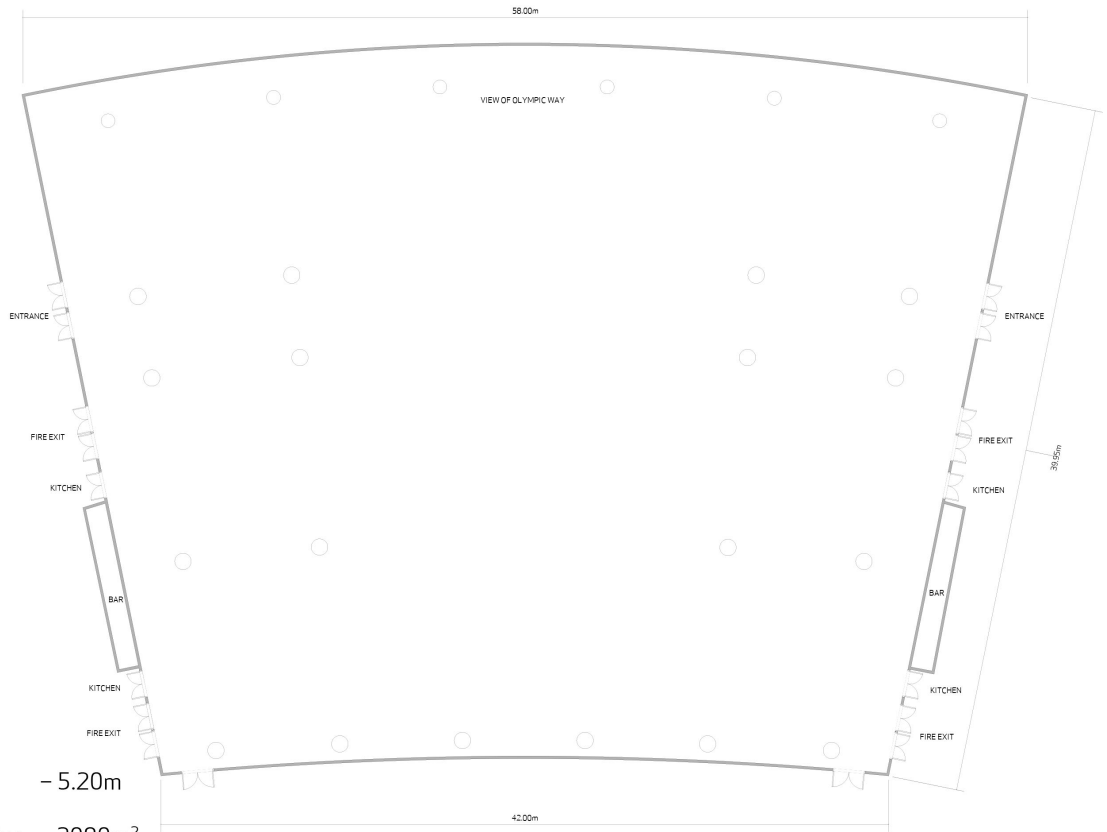

Height of ceiling

- 5.20m

Approximate overall room size - 2080m<sup>2</sup>

Three phase power available upon request.

## The Wembley Suite

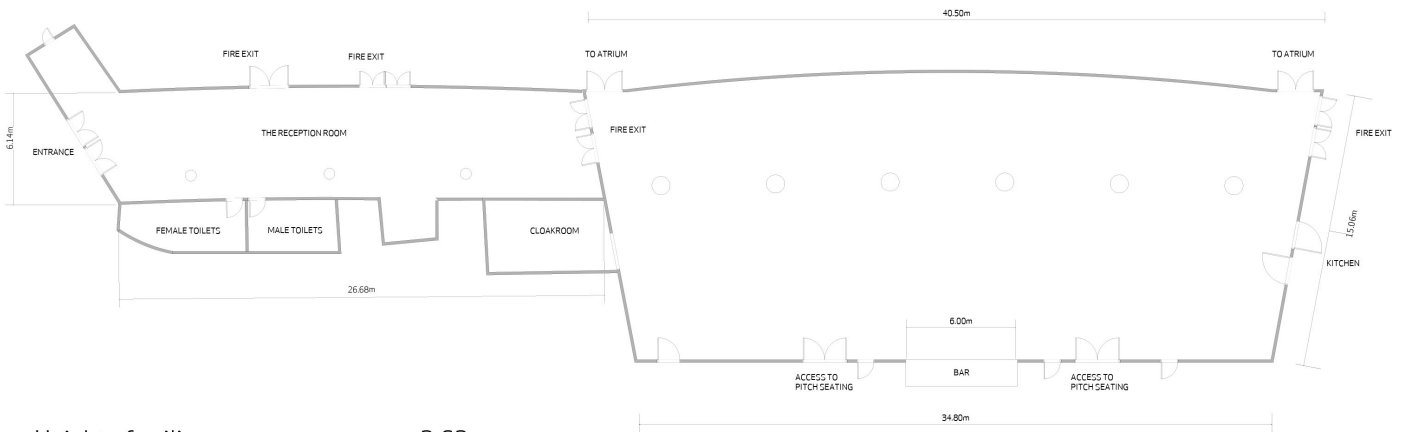

Height of ceiling

- 2.62m

Approximate function room size - 616m<sup>2</sup>

Approximate Reception room size - 150m<sup>2</sup>

Three phase power available upon request